

DAMON E

Address

58 Amblefield Common

Job#

220112

Total Sq. Ft. - 2338

Bedrooms - 4

Bathrooms - 3

Garage - 2

Floorplan

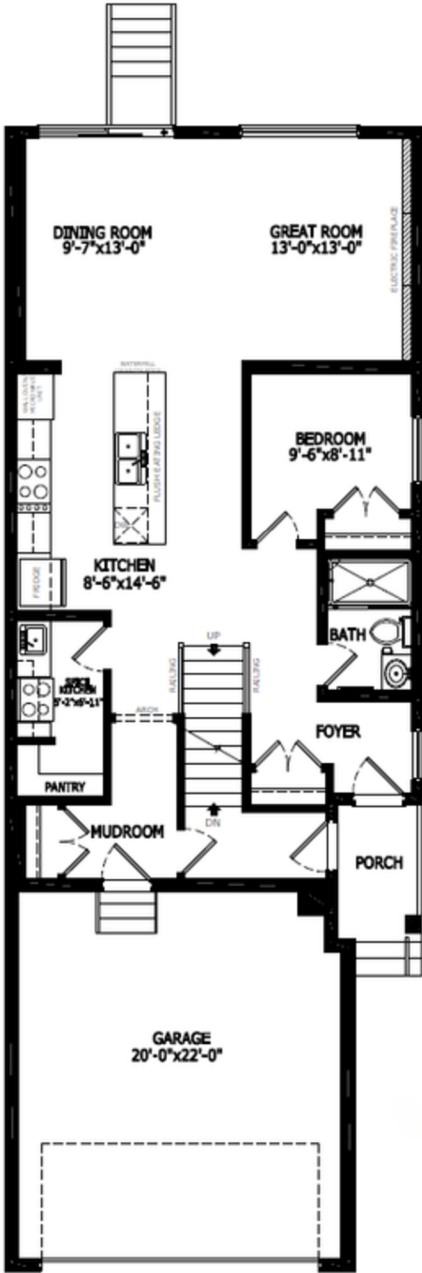

Main Level: 1031 sq. ft.



Brandi Penrose
Area Manager

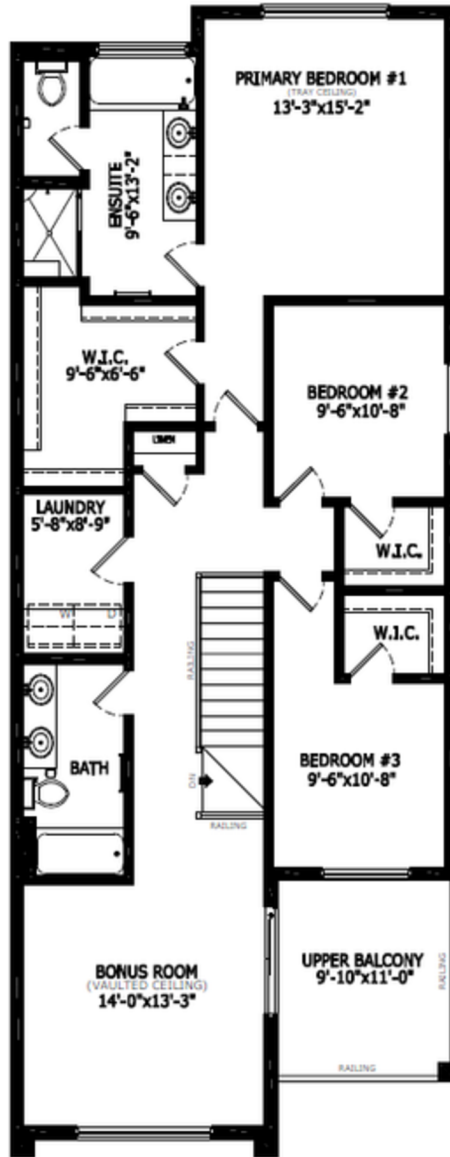

Upper Level: 1307 sq. ft.



Michael Cornell
Area Associate



Elevation



Lot Location

Contact:

P: (403)516-2288

E: Ambleton@sterlingcalgary.com

Features



What others see as optional, we make essential. Every Sterling Home is built to a higher standard with our Smart Energy package, combining energy-efficient and Smart Home features. Enjoy comfort, convenience, and savings while reducing your environmental impact. Each home is BUILT GREEN® certified with an EnerGuide rating for sustainability and efficiency.

Kitchen

- Executive kitchen and spice kitchen with stainless-steel appliances
- Quartz countertops with undermount kitchen sink
- Waterline to fridge
- Range gas line
- Corner pantry

Convenience

- 2024 Specifications
- Mudroom
- 9' basement ceiling
- Extra windows
- Gas-line for BBQ
- Upper floor laundry with quartz countertop above
- Balcony off of bonus room

Bathrooms

- 5-piece ensuite with dual sinks and soaker tub
- Tiled shower base with bench, three walls tiled and barn style door in ensuite
- Fiberglass base shower with tiled walls and barn style door in main floor bath
- Quartz countertops with undermount sinks and tiled flooring in all bathrooms and laundry room

Rest of Home

- Paint grade railings with iron spindles
- Fully tiled electric fireplace
- Vaulted ceiling in bonus room

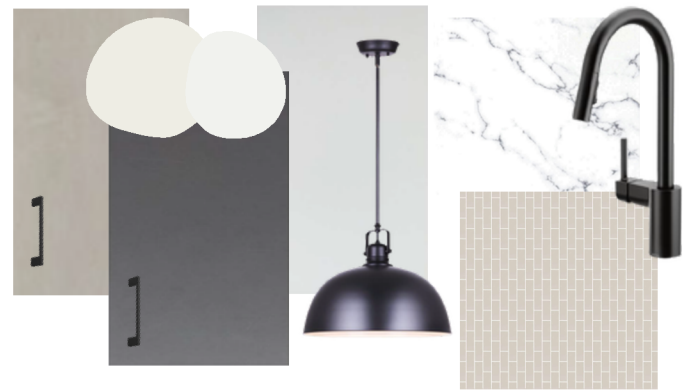

Kitchen



Home Interiors

Home Interiors