

LEGACY E

Address
77 Ranchers View

Job#
32151

 Total Sq. Ft. - 2449

 Bedrooms - 4

 Bathrooms - 2.5

 Garage - 2 Car



**Concept only, for specific elevation see reverse side.*



Homes built by Sterling Homes are 20% more energy-efficient than the average home. This means you'll enjoy lower utility bills and a more comfortable living environment, all while being kind to the planet!

Kitchen

- Executive kitchen layout
- Stainless steel appliances
- Island waterfall edge
- Silgranit sink
- Walk-through pantry
- Gas line to range
- Waterline to fridge
- Pendants over island

Convenience

- 2024 specifications
- 9' basement ceiling
- Main floor flex room
- Open to below great room
- Rear 12'6"x10' deck with BBQ gas line

Bathrooms

- Tile floors in ensuite and main bath
- Tiled ensuite shower walls with barn style door
- Bank of drawers in ensuite and main bath
- 5-piece ensuite with dual sinks and private water closet

Rest of Home

- Paint grade with iron baluster railing
- Gas fireplace



Kitchen



Home Interiors

Floorplan



Main Level: 1110 sq. ft.

Upper Level: 1339 sq. ft.



Elevation

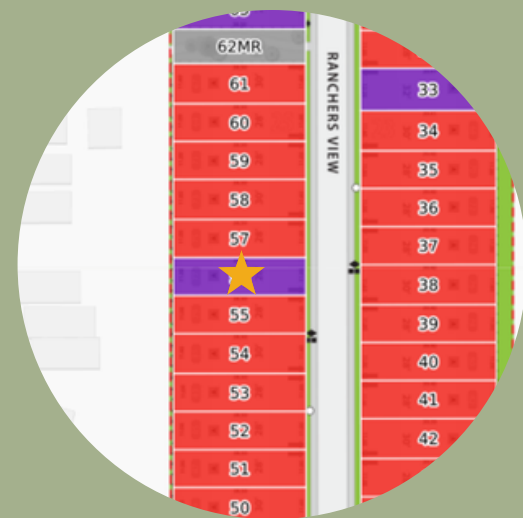

Lot Location



Shilo Hannah
Area Manager



Alexis Waterman
Area Associate



Nicole O'Dell
Area Manager

Contact:

P: (403)982-0740
E: ranchersrise@sterlingcalgary.com