

# JADE F

Address

**47 Lewiston Drive**

Job#

**940002**

 Total Sq. Ft. - 1820

 Bedrooms - 4

 Bathrooms - 2.5



\*Concept only, for specific elevation see reverse side.



Homes built by Sterling Homes are 20% more energy-efficient than the average home. This means you'll enjoy lower utility bills and a more comfortable living environment, all while being kind to the planet!

## Kitchen

- Executive kitchen with stainless-steel appliances
- Gas range
- Dishwasher in island
- Silgranit sink
- Waterfall edge countertop
- Tile backsplash

## Bathrooms

- LVP in ensuite, main bath, and laundry room
- Fiberglass base shower in ensuite with barn door
- 3-piece ensuite

## Convenience

- 2-bedroom basement suite
- 2024 specifications
- 9' basement ceiling
- W.I.C in primary bedroom
- Side entrance

## Rest of Home

- Upper floor loft with vaulted ceiling
- Upgraded windows throughout home
- Electric fireplace with tile face and maple mantle



Home Interiors

# Floorplan



Main Level: 920 sq. ft.

Upper Level: 900 sq. ft.



Elevation

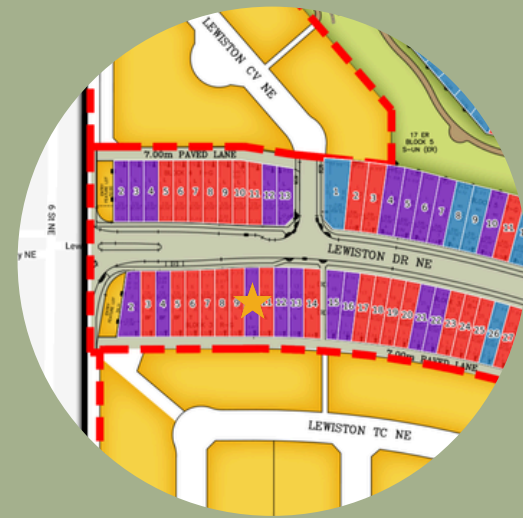

Lot Location



Raman Dhillon  
Area Manager



Jason Tang  
Area Associate

## Contact:

P: (403)453-3632

E: [lewiston@sterlingcalgary.com](mailto:lewiston@sterlingcalgary.com)