



*Concept only, for specific elevation see reverse side.



Homes built by Sterling Homes are 20% more energy-efficient than the average home. This means you'll enjoy lower utility bills and a more comfortable living environment, all while being kind to the planet!

Kitchen

- Executive kitchen with built-in stainless steel appliances
- Hood fan above cooktop
- Gas range
- Dishwasher in island
- Silgranit sink
- Walk-in corner pantry
- Tile backsplash

Bathrooms

- LVP in ensuite, main bath, and laundry room
- Tiled ensuite shower walls
- 4-piece ensuite with dual sinks and private water closet

Convenience

- 2024 specifications
- 9' basement ceiling
- Main floor flex room
- Main floor full bath with walk-in shower
- Upper floor loft with vaulted ceiling
- W.I.C in primary bedroom

Rest of Home

- 2-bed legal basement suite
- Paint grade railing with iron spindles
- Electric fireplace with tile face
- Side entrance



Kitchen



Home Interiors

Floorplan



Main Level: 920 sq. ft.

Upper Level: 900 sq. ft.



Elevation

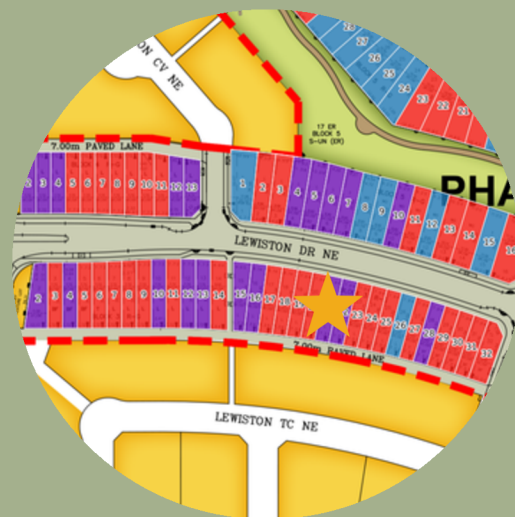

Lot Location



Raman Dhillon
Area Manager



Jason Tang
Area Associate

Contact:

P: (403)453-3632

E: lewiston@sterlingcalgary.com